

JD MICRO



Joda micro - modular lathe

Modular lathe to create your customized welding machine
The modules availables:

- *Head stock*
- *pneumatic tail stock*
- *pneumatic tail stock with rotation synchronized at the master headstock*
- *feet for horizontal or vertical standing*
- *rotating support to choose the better position of welding*
- *one or two torch supports with manual, motorized or pneumatic slides*
- *standard lenght of the bench: 1000, 1500 or 2000 mm*

CARPANO EQUIPMENT Srl

Via Cà dell'Orbo sud, 10 40055 - Castenaso (fraz.Villanova) - Bologna - Italy
Phone +39 051 6053215 fax +39 051 6053218 info@carpano.it www.carpano.it

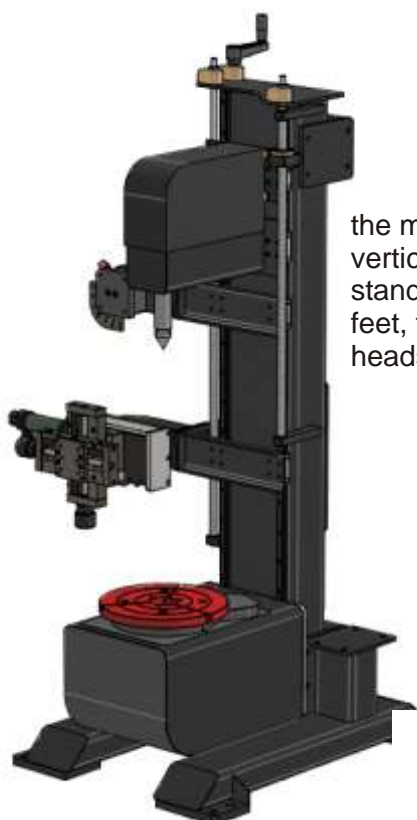

the machine is on
vertical position
standing on the 2
feet, fixed on the
headstock

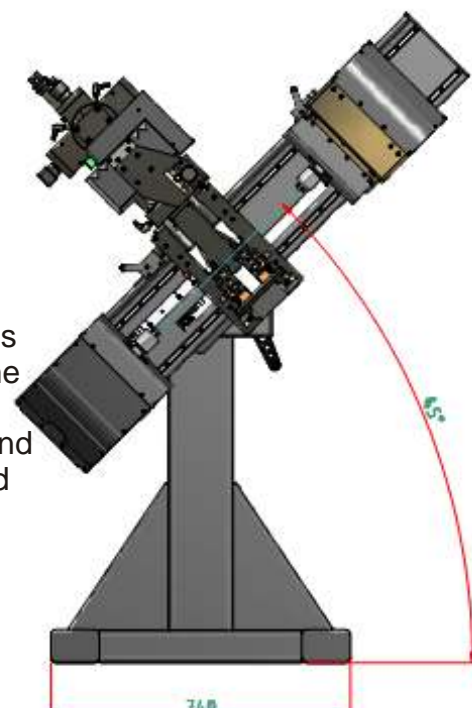

the
machine is
fixed at the
rotating
support and
positioned
at 45°

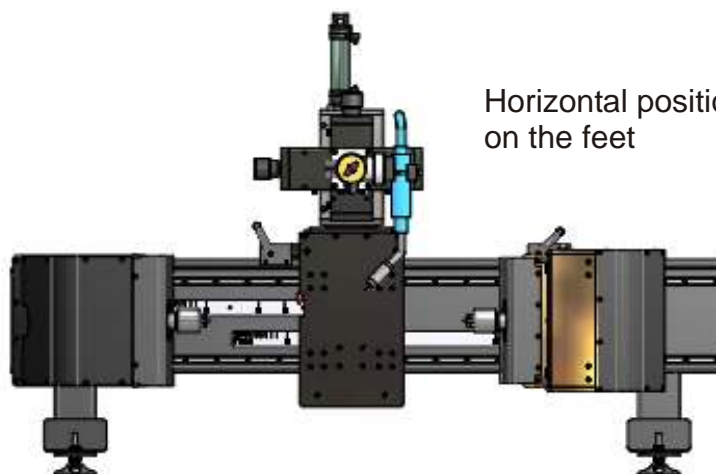

Horizontal position standing
on the feet

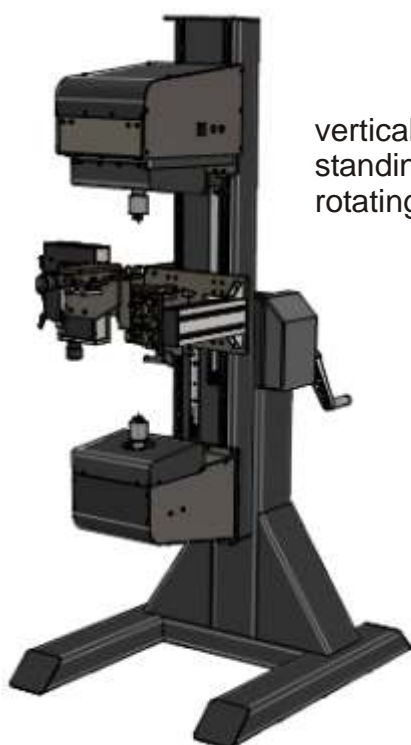

vertical position
standing on the
rotating support

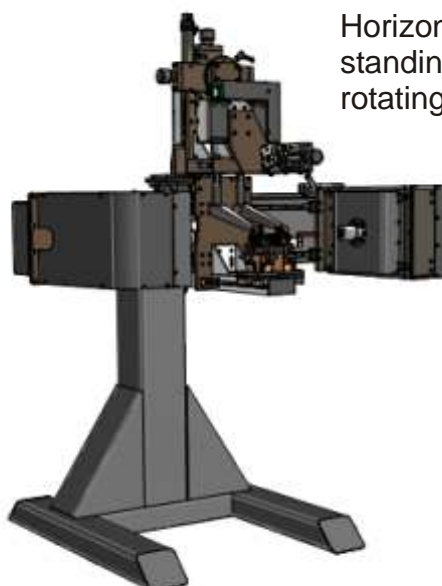

Horizontal position
standing on the
rotating support

The headstock

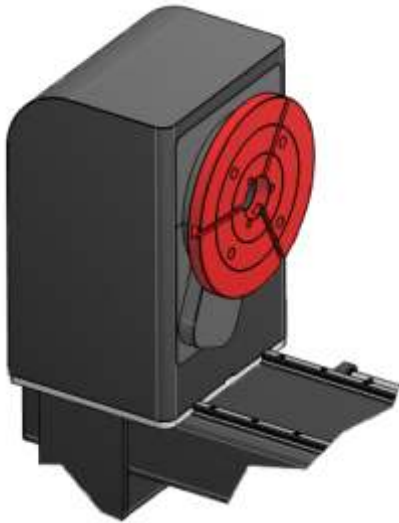

- structure is made by steel plate machined and painted
- turning plate Ø250 mm, with 3 slot at 120°
- thru-hole Ø54 mm
- DC motor with tako (or encoder if connected with CNC)
- earthing 400 amp
- max load 200 Kg
- bending moment 40 Kgm
- torque 7,4 Kgm with range speed from 0,23 to 4,5 rpm
- torque 4 Kgm with range speed from 0,6 to 11 rpm

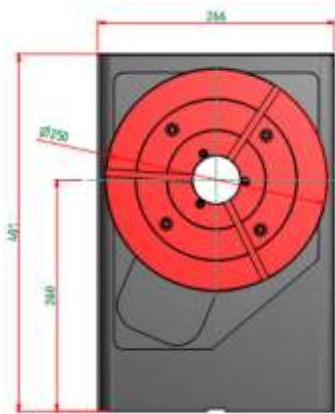

BEAM code JDMCR.B

The beam is a tubular profile 100x200 mm, machined and painted. 2 hardened guides are screwed. The beam has the place to screw the head stock, the feet or the rotating support, and the holes to fix the transmission system for the tailstock and the torch supports

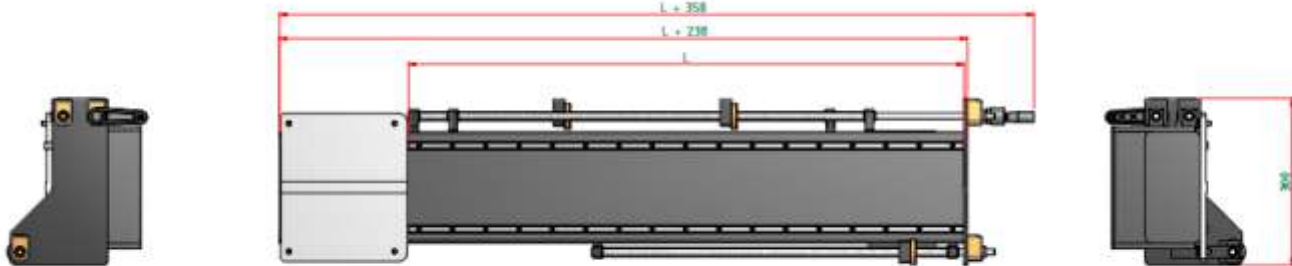

L = 1000 / 1500 / 2000

The seat of the tail stock is the standard UNI 521

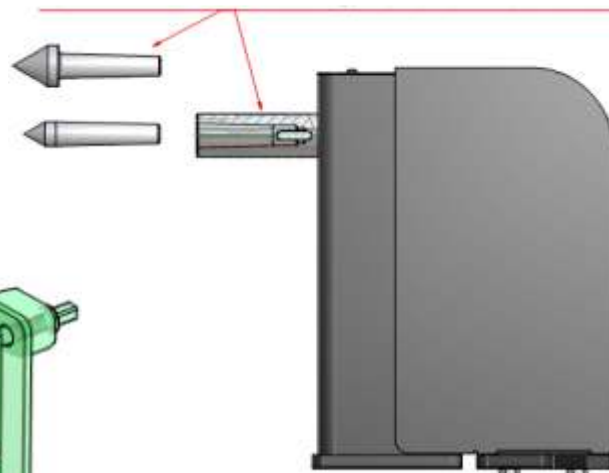
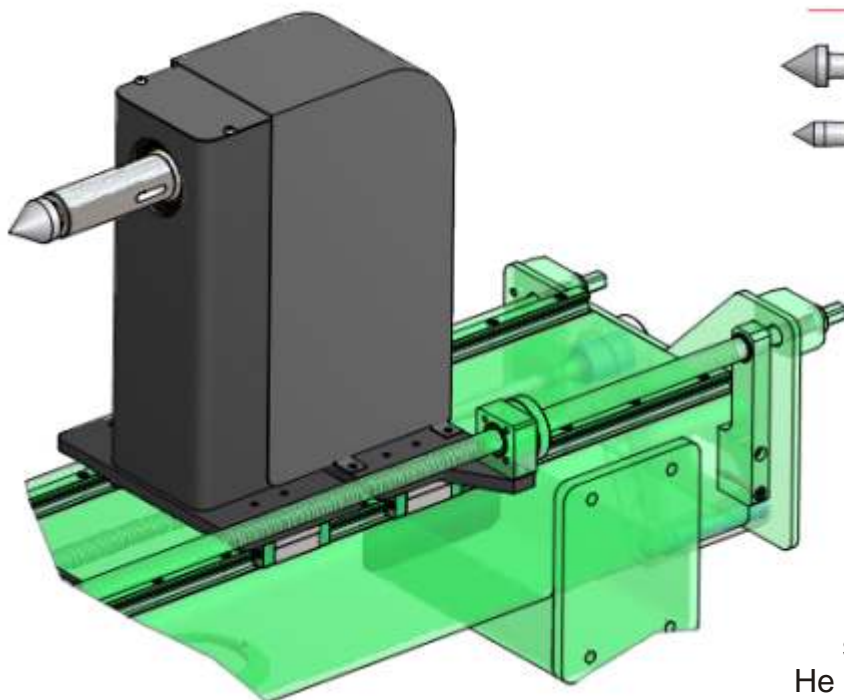

The tailstock is a plate steel structure machined and painted.
He has 4 ball bearing block sliding on the guides of beam.

A manual screw can adjust the position of the tail-stock on the beam.

- Stroke 25 mm
- max pressure at 6 bar: 180 Kg
- max flecion load on the cone point: 100 Kg

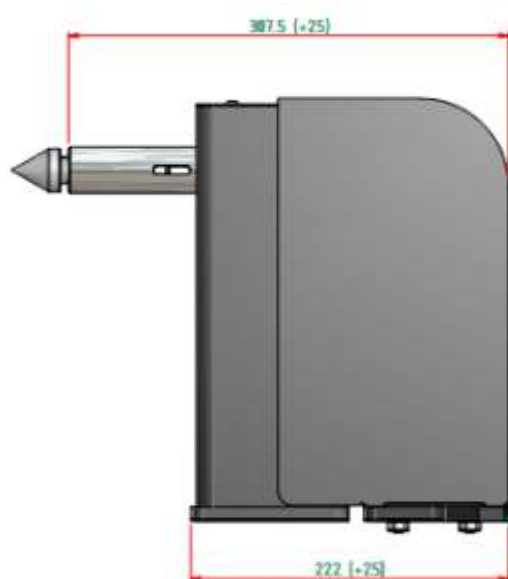

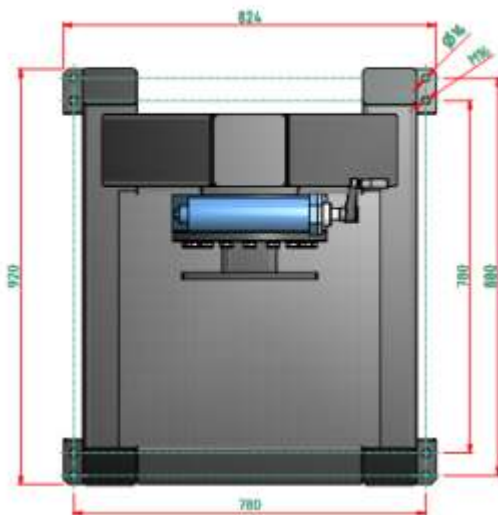
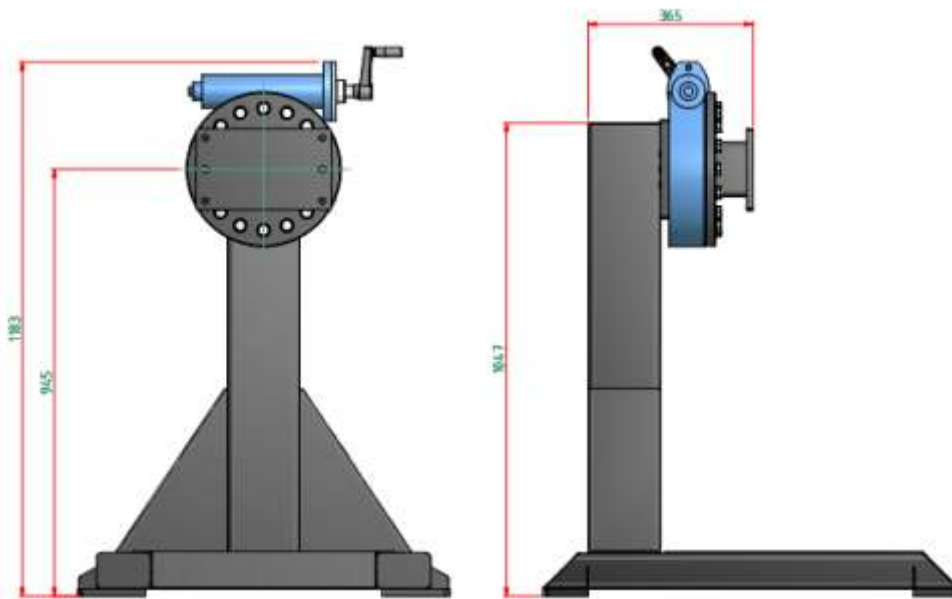

Rotating support

This part can put in rotation all the beam of the JD MICRO, with the manual hand wheel, the operator can rotate all the machine from: -90° to +90°

With a screw it is also possible to lock the system at 0, 45° and 90°



Feet couple

Steel structure welded and painted.
this feet can be fixed at the beam for a
horizontal or vertical standing of JDMICRO

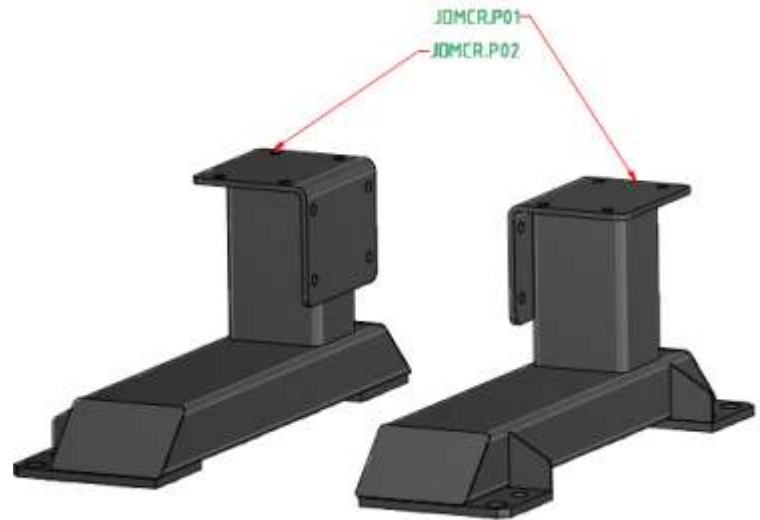
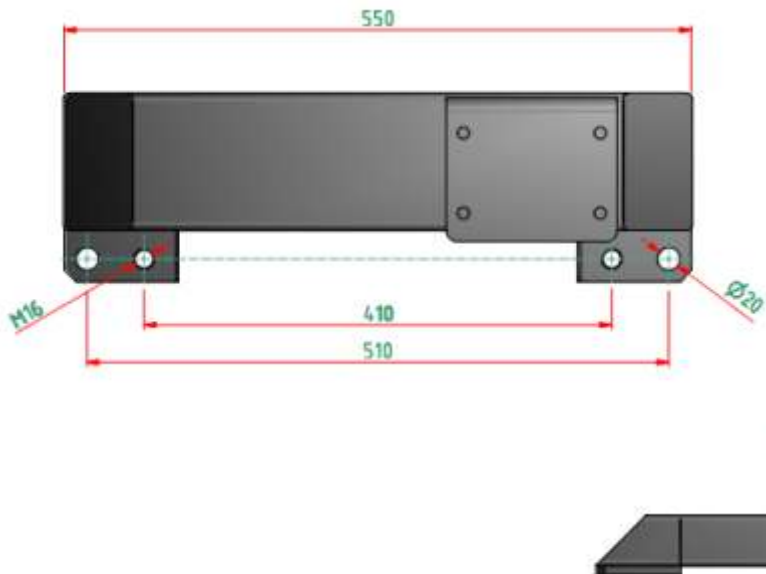

TORCH SUPPORT code JDMCR.CR

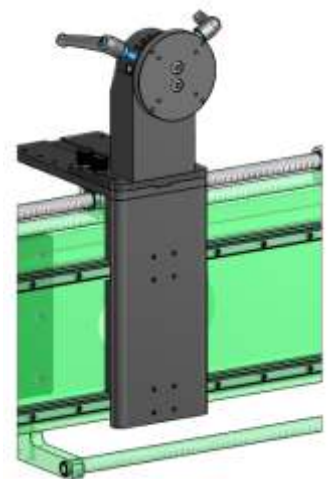
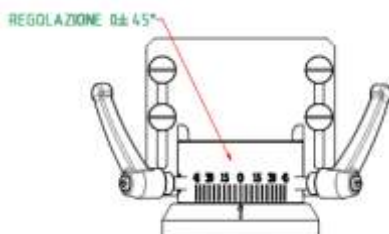
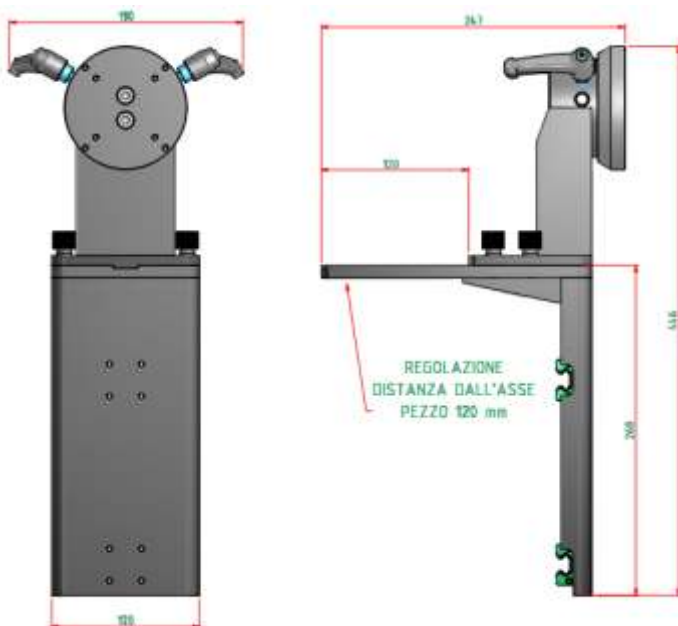

Torch support in steel plate:

- 2 ball bearing carriages, sliding on the guides of beam
- manual screw to set the position in horizontal
- rotating flange to tilt the slides, with angle indication
- possibility to fix manual or motorized slides Carpano

The control box are normally done following the need of the customer, but we can have 2 standard:

- a simple solution with a PLC LOGO Siemens
- a smart solution with a CNC SIAX 100 Sipro



JDMCR.PLC - has the following features:

- 10 turns speed potentiometer
 - start delay
 - overlap
 - selection torch contact in 2 stroke or 4 stroke
 - MIG or TIG cycle selection
- welding cycle:
- pneumatic slide down
 - ARC ON
 - Rotation (after delay) 360° + overlap
 - ARC OFF
 - Torch UP

JDMCR.CN - has the following features:

- possibility to make at least 200 different program and for each program setting of:
- speed in mm/min
- Ø of workpiece
- rotation delay
- Overlap in mm
- numbers of layers, for each layer possibility to change also the job of welding machine (option)
- programmation using arch and not turn (option)
- possibility to control 3 external axis (or more), as oscillator, AVC, or other



Complete integration

one exemple of one installation where JD MICRO is closed in a box with a sliding door and supported by a desk. At the top of the box is placed also a smoke recovery system. on the door is present a big black window to observe the welding from outside.

In this machine the CNC controls JD MICRO, the oscillator and the power source. The tailstock is motorized and synchronized at the headstock by the CNC



CARPANO
EQUIPMENT

WELDING AUTOMATION

CARPANO EQUIPMENT Srl
via Cà dell'Orbo sud, 10
40055 Castenaso fraz. Villanova
Bologna - Italy
tel. +39 051 6053215 - fax +39 051 6053218
info@carpano.it
www.carpano.it