

## IP - Column and Boom

**IP CM:** on motorized base, sliding on rails Burbac 2

**IP BF :** free standing base. without wheels and with levelling screws

an innovative C&B, with ball bearing guides on the vertical and horizontal axis, and with the lifting motor on the bottom of vertical axe, to save space in the height



# POWER

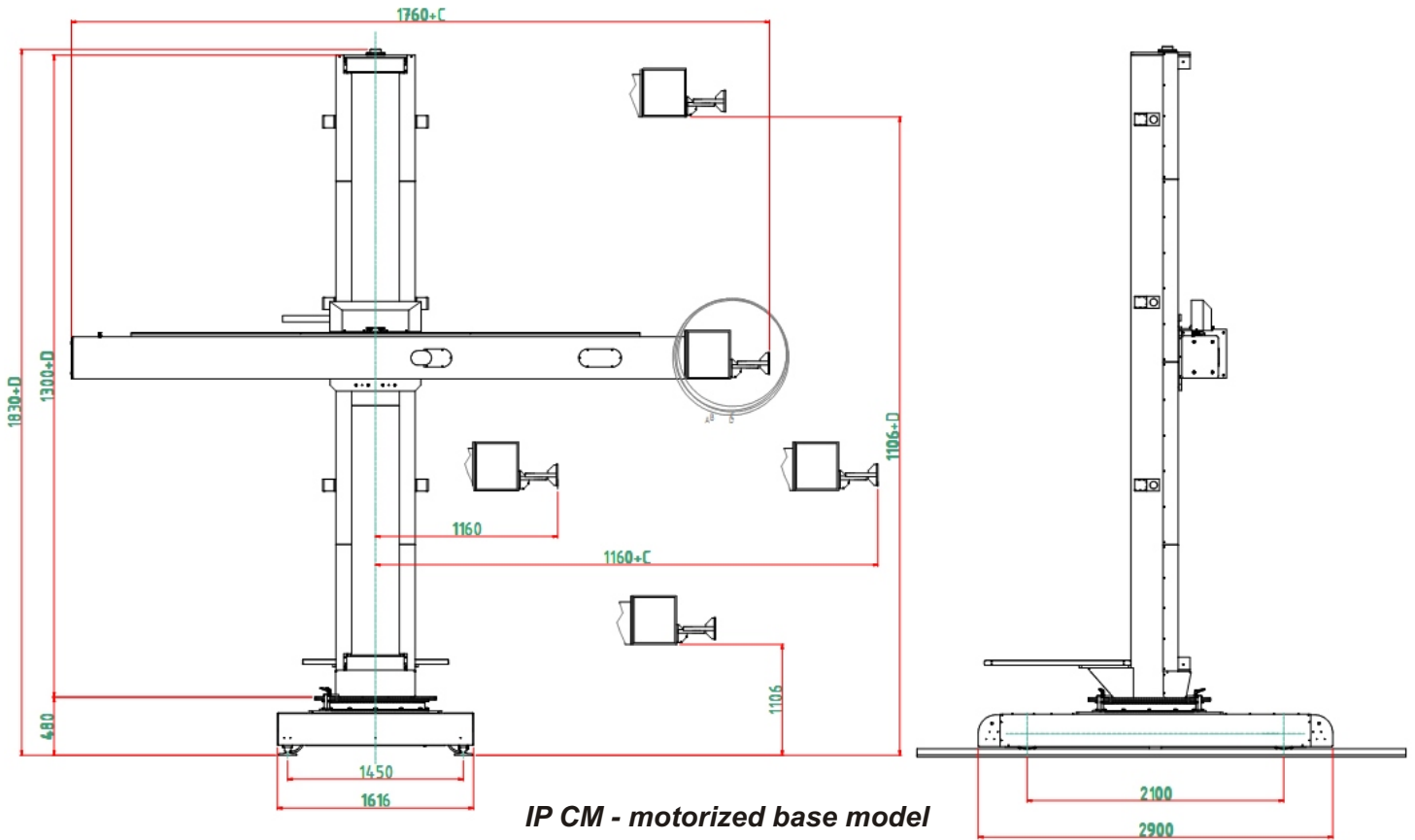

**C** horizontal useful stroke from 3 to 4 mt  
**D** vertical useful stroke, from 3 to 4 mt

Carpano suggest to use rails Burbac 2 for the motorized base, machined on the top face. And install a cable carrier parallel to the rails

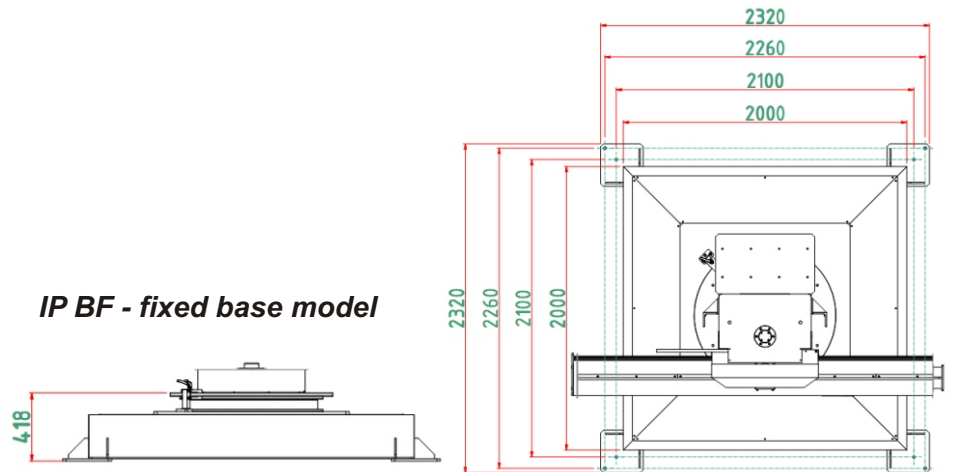

## technical features

Max load on the arm	250 Kg (IP4x4) and 300 Kg (IP3x3)
Motorized base motor	AC 0,75 Kw servo fan cooled
Base gearing	with pinion and rack, with idler
Motorized base speed	from 150 to 3000 mm/min, with vectorial inverter
Arm motor	AC 0,18 Kw servo fan cooled
Arm gearing	with pinion and rack
Arm speed	from 100 to 2000 mm/min, with vectorial inverter
Arm lifting	with trapezoidal screw, anti-fall device with rubbing wear monitoring
Lifting motor	AC 1,8 Kw with brake
Lifting speed	980 mm/min fixed
Arm and column sliding	on hardened ball bearing linear guides
Column rotation	manual of 360°, with ball bearing slewing ring, with 2 manual brakes
Cable carrier belt	in PVC, on the vertical and horizontal axis
Power	400 V, 3 phases, 2 Kva

# POWER

A platform is screwed on the base of column to support some device as:  
power source, cooling system, smoke recovery system.. and other.  
the standard size is 1x1 mt,  
but on demand we can do also other dimensions

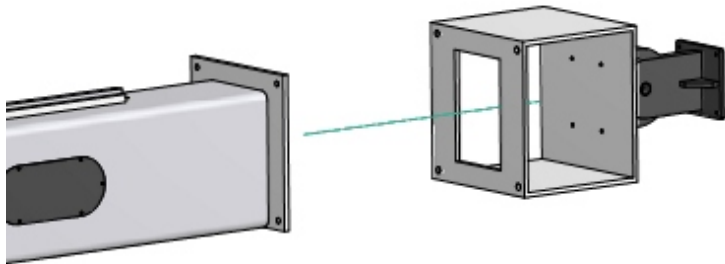
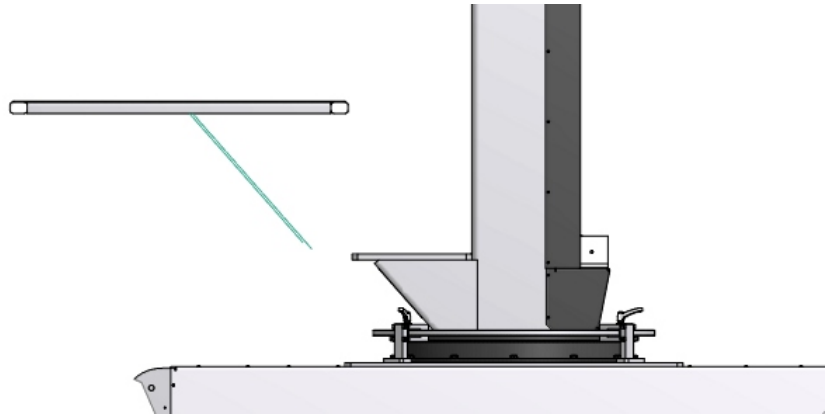

At the end of arm is fixed a frame to protect the control of welding head

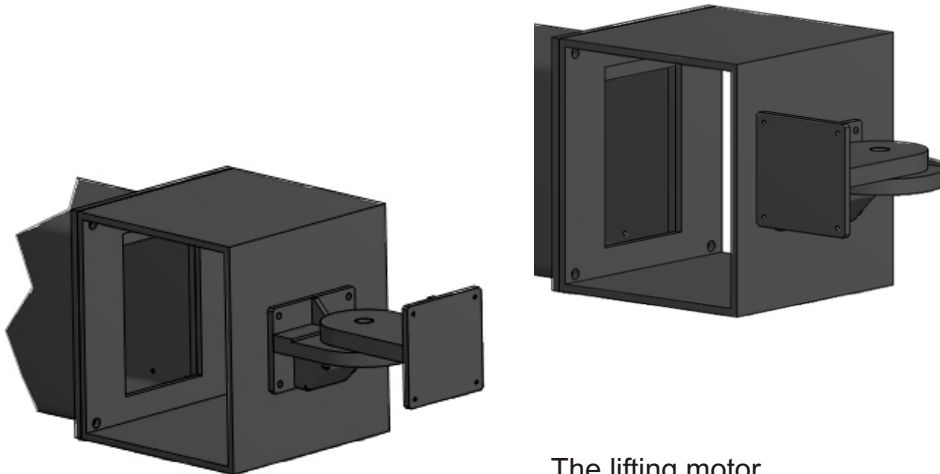

On the frame is positioned a device to rotate the welding head from 0° to 90°.  
The holes on this device are the same of the motorized slides Carpano MM MIDI

The lifting motor is at the base of column to have less height obstacle

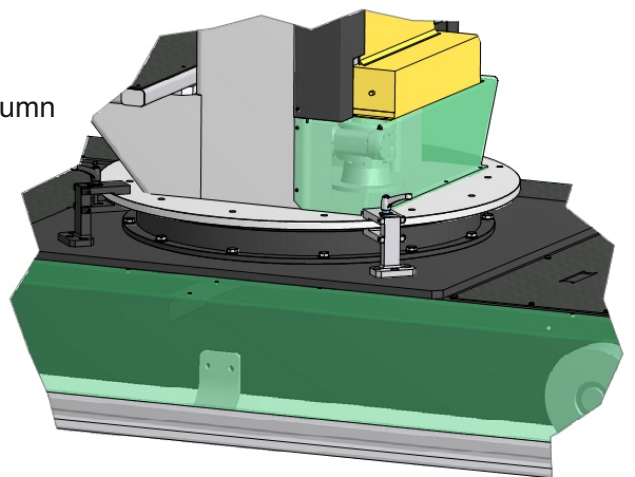

anti-crushing bumper in front and rear of motorized base

# POWER



I Power can be done also with the fixed arm and with sliding motorized carriages. Normally this model is a good solution to weld with 1 or 2 head H or I beam, or train panel. In the picture is installed 1 MIG head on the carriage with a vertical slide MM MIDI. The carriage and the slide are controlled by a tactile seam tracker



## accessories

Due versioni di telecamera per arco aperto (MIG - TIG - Plasma) o per SAW, per osservare a distanza il processo evitando all'operatore insalubri e pericolose posizioni di lavoro



Wireless remote control



Laser spot to indicate the wire position in the SAW welding



wide range of motorised slide with manual or automatic guide

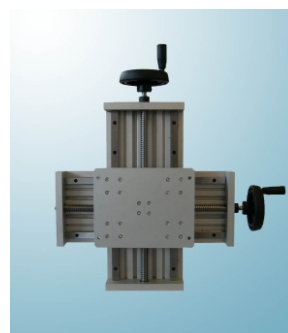

wide range of manuale slide to complete the welding head.